



Templefield Close, Addlestone, KT15 1LR



Situated in a popular and convenient location in the heart of Addlestone, this well presented three bedroom home offers well-balanced accommodation arranged over two floors. The ground floor features a generous lounge/diner, ideal for both relaxing and entertaining, alongside a separate fitted kitchen. To the first floor are three well-proportioned bedrooms and a modern family bathroom suite.

Externally, the property enjoys a low-maintenance landscaped rear garden which backs directly onto the attractive Sayes Court open space, providing a pleasant outlook and an added sense of privacy. The property further benefits from two off-street parking spaces, and would make an ideal choice for families or those seeking comfortable living in a highly regarded location. Offered to the market with no onward chain.

Freehold



# Templefield Close, KT15

Approximate Gross Internal Area = 79 sq m / 849 sq ft  
For Identification Only - Not to scale

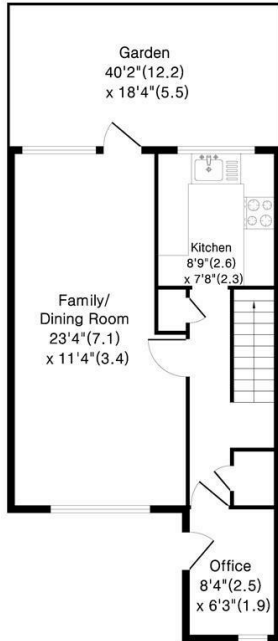

Ground Floor

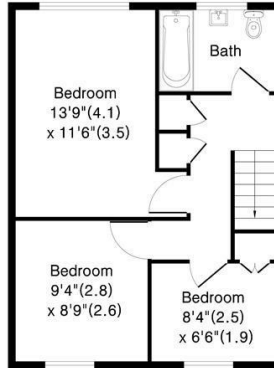

First Floor

Floor plan Produced in accordance with RICS Property Measurement 2nd Edition,  
Incorporating International Property Measurement Standards (IPMS2 Residential).



EPC Rating: 71 C





Grants Homes 60 Church Street, Weybridge, Surrey, KT13 8DL  
T: 01932 858885 E: [addestone@grantshomes.co.uk](mailto:addestone@grantshomes.co.uk)

